

Servo Weld Guns – VC TYPE

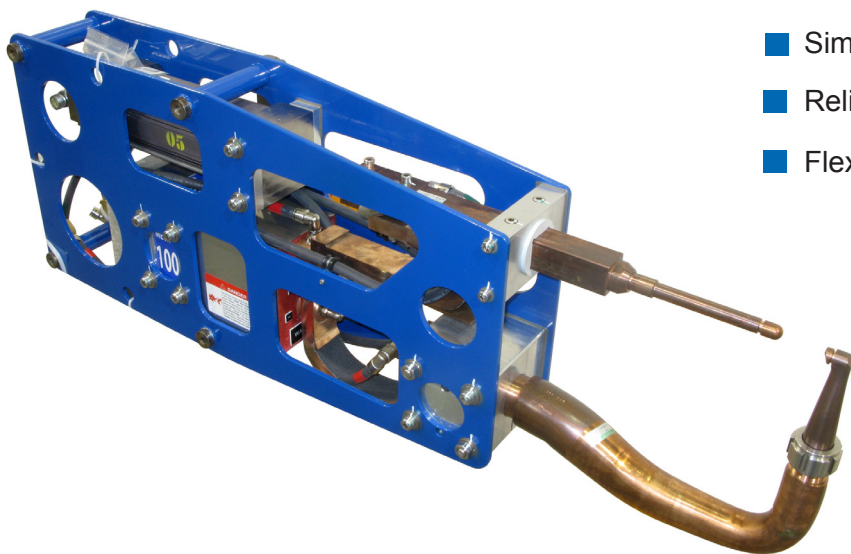

- Simplicity: < 12 parts
- Reliability: > 2M MTBF
- Flexibility: > 100% Bodyshop

■ The all new Comau VersaGun sets the new global benchmark for simplicity, reliability, flexibility, and low cost. Virtually all of the standard gun configurations can be assembled from one of the three Base Gun Assemblies (BGA) and interchangeable components. For most applications only the aluminum arms and electrodes are task specific. This enables very short lead times, reduced spare parts and simplification of system/process design

LIBRARY WELD GUNS



6 Weld guns with copper arms

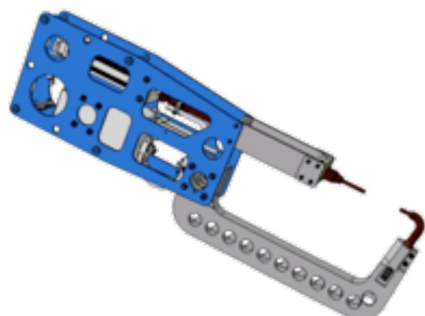

1 Weld gun with aluminum arms

- No design time
- Robcad component with kinematics
- Available with $\varnothing 16$ or $\varnothing 20$ caps
- Maximum welding force: 450/550 daN

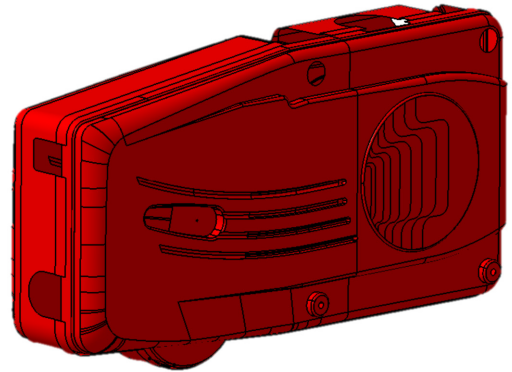
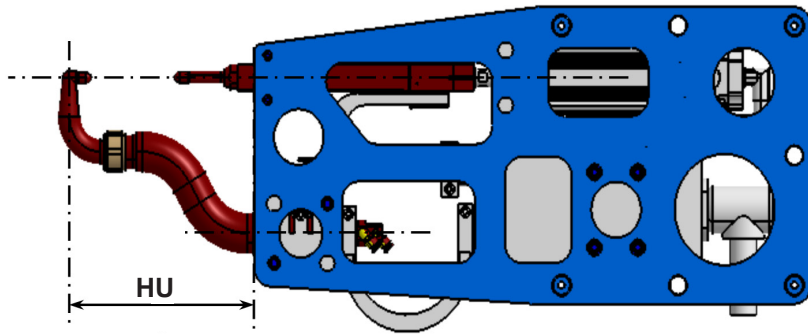

Product Includes

- VersaGun Base Gun Assembly
- Calibrated "Comau Servo Actuator" (inverted roller screw)
- 100 KVA MFDC Transformer
- Secondary Toroid Coil for Weld Current Monitoring
- Robifix Multi-Contact Primary Receptacle
- 17 pin connector I/O receptacle
- Water Hose Package
- Standard bracket
- Secondary Voltage Feedback Cable
- Product Manual on CD

Product Options

- Custom "Product / Process" special Arms
- Cover fireproof material
- Servo: ABB, Fanuc, Kawasaki, Kuka, Nachi, Motoman
- AC Transformer
- Communications: DeviceNet, Profibus, Interbus, ProfiNet

Warranty

Two years

Versagun "VC" type

Dimension	Min. - Max	Arms
HU	250mm -450mm	Copper
HU	500mm -700mm	Aluminum

Product Specifications	
Servo Force Capacity	793 daN
Weld Tip Speed	250mm-600mm/sec
Trans. AC/MFDC	65KVA – 100 KVA
Water Requirements	10 l/min. @ 2 Bar
Product Weight	100 Kg – 120 Kg
Electrical Tolerance	+/- 10% of stated Voltage
Height	500mm+
Length	700mm+
Width	170mm
MTBF	2,000,000 cycles
MTTR	15 minutes